

CRL STA. 12+89.22
 W. RENO AVE. =
 CRL STA. 9+49.29
 WESTERN /
 CLASSEN AVE.
 N= 169,340.2506
 E= 2,108,434.9922

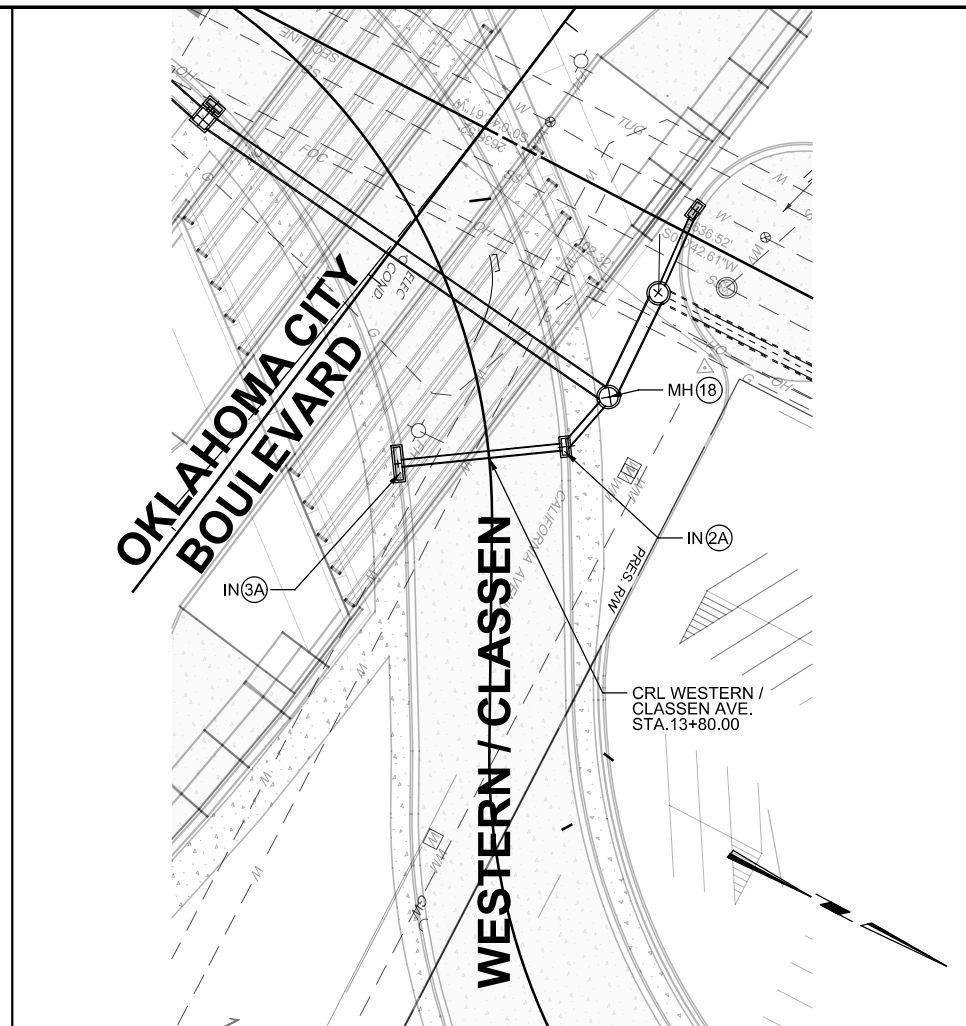

CRL WESTERN /
 CLASSEN AVE.
 STA. 13+80.00

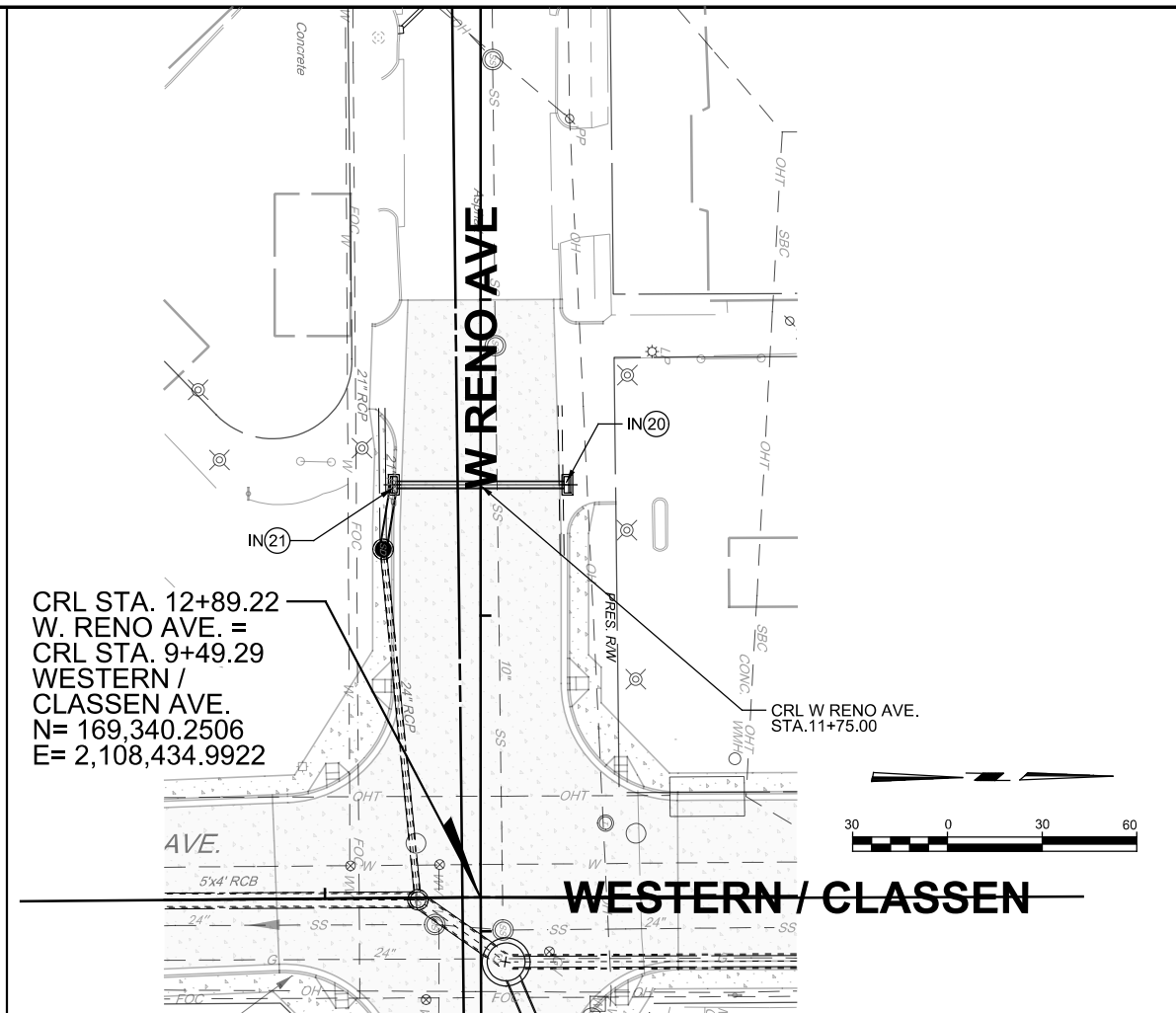

CRL STA. 12+89.22
 W. RENO AVE. =
 CRL STA. 9+49.29
 WESTERN /
 CLASSEN AVE.
 N= 169,340.2506
 E= 2,108,434.9922

CRL W RENO AVE.
 STA. 11+75.00

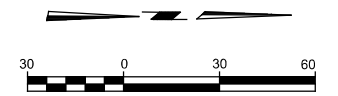

1195	STR. IN 2 STA. 8+45.00, 31.13' LT. CONST. CIDES, 2 (C) W/ 31.13 L.F. 18.00' RCP STUB INTO MH 2 TG= 1186.90' (E) FL OUT= 1183.73' EXIST. WATER LINE CROSSING EXACT DEPTH UNKNOWN	1195	1200	STR. IN 3A STA. 13+80.00, 28.41' RT. CONST. CIDES, 3 (STD.) W/ 52.41 L.F. 24.00' RCP STUB INTO IN 2A TG= 1191.78' (NW) FL OUT= 1188.00' CRL WESTERN / CLASSEN	1200	1195	STR. IN 21 STA. 11+58.60, 27.50' RT. CONST. CIDES, 2 (C) W/ 27.50 L.F. 24.00' RCP STUB INTO X-MH 3 TG= 1186.51' (E) FL OUT= 1181.63' (N) FL IN= 1181.60'	1195	STR. IN 20 STA. 11+58.60, 27.50' LT. CONST. CIDES, 2 (B) W/ 55.00 L.F. 24.00' RCP STUB INTO IN 21 TG= 1186.51' (S) FL OUT= 1181.71'	1195
1190	STR. IN 3 STA. 8+45.00, 23.90' RT. CONST. CIDES, 2 (C) W/ 23.90 L.F. 18.00' RCP STUB INTO MH 2 TG= 1187.04' (W) FL OUT= 1183.87'	1190	1195	EXIST. WATER LINE CROSSING EXACT DEPTH UNKNOWN	1195	1190	CRL RENO AVE	1190		1190
1185	EXISTING GROUND	1185	1190	EXISTING GROUND	1190	1185	EXISTING GROUND	1185	EXISTING GROUND	1185
1180	CONST. 18" RCP 31.13 L.F. AT 0.10%	1180	1185	CONST. 24" RCP 52.41 L.F. AT 0.40%	1180	1180	CONST. 24" RCP 55.00 L.F. AT 0.20%	1180		1180
1175	STR. IN 2, STR. IN 3 WESTERN / CLASSEN STA. 8+45.00	1175	1180	STR. IN 2A, STR. IN 3A WESTERN / CLASSEN STA. 14+00.00	1180	1175	STR. IN 21, STR. IN 20 RENO AVE. STA. 11+75.00	1175		1175
1170		1170	1175		1175	1170				1170

PRINT DATE: 8/11/2017 T:\1024-05\Drawings\Roadway\Prelim\Prn\Prs\1024-05 STRMpp03.dgn